

**2005 CMS/FORUM OF ESRD NETWORKS'
ANNUAL MEETING**

**Strategic
Partnership for
Change**



March 14-17, 2005

**Baltimore Marriott Inner Harbor
at Camden Yards**

**2005 CMS/FORUM OF ESRD NETWORKS'
ANNUAL MEETING**

**Strategic
Partnership for
Change**



March 14-17, 2005

**Baltimore Marriott Inner Harbor at
Camden Yards**

**CMS and the Forum of ESRD Networks
welcome you to Baltimore!**



Dear Participants,

On behalf of the Centers for Medicare & Medicaid Services (CMS) and the Forum of ESRD Networks, I welcome you to Baltimore for the “2005 CMS/Forum of ESRD Networks Annual Meeting”. The theme of this year’s Meeting is “Strategic Partnership for Change.” Over the next four days, you will have the opportunity to participate in general and training sessions addressing this theme.

The program on Monday includes CMS panel presentations on working together as partners to make a difference and a CMS dialogue with the renal community. CMS general sessions include updates on topical issues such as payment and ESRD demonstration projects. On Tuesday Tom Wolff, PhD, and his associates will facilitate a training session on partnership and coalition building. Wednesday’s agenda includes general sessions on disaster response planning, an update on the decreasing dialysis patient-provider conflict project, and words of shared advice on the journey to performance excellence from a Baldrige National Quality Program award winner. In the afternoon, a quality track and information technology track will address issues of importance to all participants. Thursday general sessions include an introduction to the ESRD Immunization Breakthrough Initiative, an update on the national patient safety efforts, and a discussion of the newly released Conditions for Coverage. The CMS Administrator will close the meeting with an announcement about the FistulaFirst Breakthrough Initiative.

Monday’s luncheon will feature Sekou Sundiata’s experience with the life-threatening kidney failure and recovery through organ transplantation. He tells his story with honesty and humor and blends the forms of theatrical monologue, literary reading, stand-up comedy, spoken word performance, and great storytelling.

We hope that you will join us for the poster sessions, which will include displays addressing both ongoing quality improvement initiatives and renal community partnerships in the Networks. A reception will be held on Monday night to showcase the posters.

Finally, we hope that you will enjoy the opportunity to interact with your colleagues and renal community partners throughout the meeting and to explore Baltimore’s beautiful Inner Harbor.

I would like to take this opportunity to thank the 2005 Planning Committee, who worked diligently throughout the year to plan this meeting.

Joan C. Solanchick, RN, MSW
Executive Director, Network 3, and 2005 Program Chair

2005 Annual Meeting Planning Committee

Joan Solanchick, RN, MSW	Network 3
Lisa Taylor, BSN, RN	Network 12
Bonnie Freed, RN, MBA	Network 4
Linda Duval, RN, BSN	Network 13
Sarah Yelton, RN, CNN	Network 12
Dean Morris, MSSA	Network 4
Cecilia Torres-Correa, RN, BSN	Network 18
Chris Brown	Network 3
Nancy Carlson, MPA	Network 14
Gina Clemons, MHA	CMS
Linda Okimoto	CMS
Condict Martak, RN	CMS
Matthew Leipold	CMS
Eileen Zerhausen, RN	CMS
Janet Crow, MBA	Forum
Lori Buikema	Forum
Bonnie Freshly, MEd	Forum



GENERAL MEETING MATERIALS

Conference Goals.....	1
General Information.....	2
Hotel Floor Plan.....	3
Meeting Overview.....	4
Program Agenda.....	5
Distinguished Speakers.....	9
Poster Session-List of Abstracts.....	16
2006 Annual Meeting Announcement.....	54
Notes.....	55

Note: The presentation materials included herein reflect the most current information available at the time these materials were printed. The speakers reserve the right to make changes/additions to their individual presentations.



CONFERENCE GOALS

- Meet, work, learn, and exchange information with Network colleagues, CMS officials, and other members of the renal community
- Participate in a dialogue between CMS Directors and the renal community
- Learn about payment for outpatient maintenance dialysis services
- Engage in the motivational presentation based upon real life experiences with the life-threatening illness of kidney failure and recovery through organ transplant
- Use examples of partnership presented to develop other approaches in working together to make a difference in ESRD patient care
- Attend the 2005 Forum Membership Annual Meeting
- Study ongoing quality improvement activities and successful renal partnerships at the poster session
- Learn how to use collaboration and coalition building to strengthen strategic partnerships
- Obtain tools to be used to decrease dialysis patient-provider conflict
- Apply what is transferable from one organization's journey to performance excellence
- Engage in one of two specific program tracks geared for professional growth in Quality or Information Technology
- Join your colleagues as they are introduced to the ESRD Breakthrough Initiatives
- Attend a session on patient safety and hear about best practices
- Engage in an exchange on the ESRD Conditions for Coverage

General Information

Meeting Registration Desk

The conference registration desk will be open on Monday, March 14, Tuesday, March 15, Wednesday, March 16, and Thursday, March 17 from 7:30 AM-5:00 PM. Please contact the registration table staff for urgent messages and/or lost and found items. During the Meeting, the following individuals will be available to assist you:

Lori Buikema Judi Persichetti Sarah Crow

Cell Phones and Pagers

Please turn all cell phones and pagers off or to vibrate while in the meeting rooms.

Recycling

A recycling bin will be available at the meeting registration desk. If you do not wish to keep your meeting materials (including paper, nametags, folders, and binders), please return them to the registration desk.

Evaluations

Please take time to complete the green Evaluation Form at the end of each session. Completed forms can be returned to the meeting registration desk. Your feedback will help evaluate the quality of the meeting and influence for next year's meeting planning.

Poster Session

Please bring all posters to the Salon ABC or Patapsco/Severn Rooms to display by 7:15 AM on Monday, March 14, 2005. Each Network is responsible for removing its own posters by 6:00 PM on Tuesday, March 15, 2005.

CEU Information

Please complete Contact Hour Certificate available at the registration desk. Return the yellow copy to the registration desk at the end of your last session, keep the white copy for your records. You must complete and return this form for full educational credit.

This educational activity has been approved by the American Nephrology Nurses' Association (ANNA) which is accredited as a provider and approver of continuing education (CE) by the American Nurses Credentialing Center-Commission on Accreditation (ANCC-COA). ANNA is an approved provider of CE in nursing by the California Board of Registered Nursing, BRN Provider No. 00910, and the Kansas State Board of Nursing, Provider No. LT 0148-0738. This course offering is applicable for RN and LPN licensure in Kansas. The Maryland State Board of Social Work Examiners certifies that this program meets the criteria for **23.5** credit hours of Category I continuing education for social workers

Check Out

Guest room check out is 12:00 noon for Marriott guests. Please see hotel staff if you wish to store your bags.

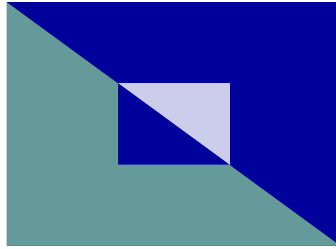

FLOOR PLAN

BALTIMORE MARRIOTT INNER HARBOR AT CAMDEN YARDS

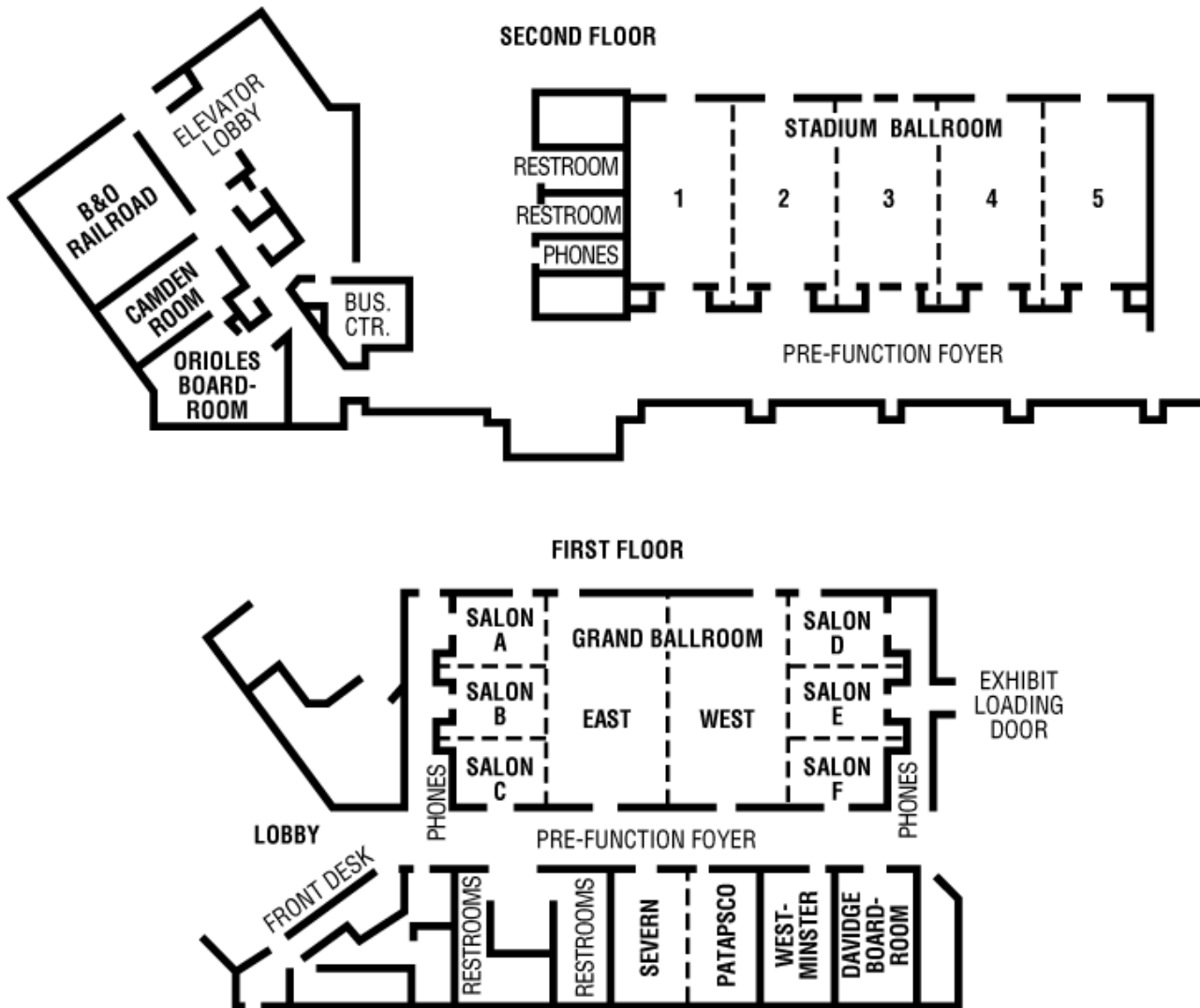

MEETING OVERVIEW

MONDAY, MARCH 14, 2005

7:30 AM - 5:15 PM	Registration table open/posters on display	Salon ABC and Patapsco/Severn
7:30 AM - 8:30 AM	Continental Breakfast	Grand Foyer
8:30 AM - 8:45 AM	"Welcome and Opening Remarks"	East West DEF
8:45 AM - 10:30 AM	"CMS Dialogue with the Renal Community: CMS Directors' Panel"	East West DEF
10:30 AM - 10:45 AM	Break	Grand Ballroom Foyer
10:45 AM - 11:45 AM	"Payment for Outpatient Maintenance Dialysis Services Furnished by ESRD Facilities - Paying for Services in the ESRD Program"	East West DEF
11:45 AM - 12:30 PM	Luncheon	Stadium Ballroom
12:30 PM - 2:00 PM	"An Artist's Journey Through Transplantation and Recovery"	East West DEF
2:00 PM - 3:45 PM	"Working Together to Make a Difference - Roles & Responsibilities & Examples of Successful Renal Partnerships" Panel	East West DEF
3:45 PM - 4:00 PM	Break	Grand Ballroom Foyer
4:00 PM - 4:45 PM	"Can We Do Things Better? ESRD Disease Management Demonstration"	East West DEF
4:45 PM - 5:30 PM	2005 Forum Membership Meeting	East West DEF
5:30 PM-7:30 PM	Poster Reception: "Quality Partnerships"	Salon ABC

TUESDAY, MARCH 15, 2005

7:30 AM - 5:15 PM	Registration table open posters on display	Grand Foyer
7:30 AM - 8:30 AM	Continental Breakfast	Grand Ballroom Foyer
8:30 AM - 10:30 AM	Training Session: "Strategic Partnership for Change"	East West DEF
10:30 AM - 10:45 AM	Break	Grand Ballroom Foyer
10:45 AM - 12:15 Noon	Training Session, continued	Grand Ballroom Foyer
12:15 - 1:15 PM	Luncheon (Buffet)	Stadium Ballroom
1:15 PM - 3:00 PM	Training Session, continued	East West DEF
3:00 PM - 3:15 PM	Break	Grand Ballroom Foyer
3:15 PM - 4:30 PM	Training Session, continued	East West DEF

WEDNESDAY, MARCH 16, 2005

7:30 AM - 5:15 PM	Registration table open	Grand Foyer
7:30 AM - 8:00 AM	Continental Breakfast	Grand Ballroom Foyer
8:00 AM - 9:15 AM	General Session: "ESRD Disaster Response Planning"	East West DEF
9:15 AM - 10:00 AM	General Session: "Decreasing Dialysis Patient-Provider Conflict"	East West DEF
10:00 AM - 10:15 AM	Break	Grand Ballroom Foyer
10:15 AM - 11:45 AM	General Session: "Our Journey to Performance Excellence"	East West DEF
11:45 AM - 1:15 PM	Lunch - on your own	
1:15 PM - 3:00 PM	Open Specialist Meetings	West DEF
Track 1: 1:15 PM - 3:00 PM	Quality Track: "Quality, Quality, Quality!"	
Track 2: 1:15 PM - 3:00 PM	Information Technology Track: "CROWN/Web Requirements"	East
3:00 PM - 3:15 PM	Break	Grand Ballroom Foyer
3:15 PM - 5:00 PM	Open Specialist Meetings continued	
Track 1: 3:15 PM - 5:00 PM	Quality Track: "Quality, Quality, Quality!"	West DEF
Track 2: 3:15 PM - 5:00 PM	Information Technology Track: "CROWN/Web Requirements"	East

THURSDAY, MARCH 17, 2005

7:30 AM - 12:15 PM	Registration Table Open	Grand Foyer
7:30 AM - 8:00 AM	Continental Breakfast	Grand Ballroom Foyer
8:00 AM - 10:00 AM	General Session: "Promoting Adult Immunizations"	West DEF
8:00 AM - 10:00 AM	Closed Specialist Business Sessions - Network Data Managers	TBA
10:00 AM - 10:15 AM	Break	Grand Ballroom Foyer
10:15 AM - 10:45 AM	General Session: "National Patient Safety Initiative"	West DEF
10:45 - 11:30 AM	General Session: "Conditions for Coverage Decisions"	West DEF

Program Agenda

MONDAY, MARCH 14, 2005

7:30 AM - 5:15 PM	Registration table open
7:30 AM - 5:15 PM	Poster Display
7:30 AM - 8:30 AM	Continental Breakfast
8:30 AM - 8:45 AM	“Welcome and Opening Remarks” <i>Sean Tunis, MD, Director and Chief Medical Officer, OCSQ, CMS, and Derrick Latos, MD, MACP, President, Forum Board of Directors</i>
8:45 AM - 10:30 AM	“CMS Dialogue with the Renal Community: CMS Directors’ Panel” <i>Gina Clemons, Moderator, CMS Liz Goldstein, PhD, CMS/CBC/BEAG/DBA Thomas Hamilton, CMSO/Survey & Certification Group Lisa Hines, MS, BSN, CMS/QMHAG/OCSQ William Rollow, MD, CMS/OCSQ/QIG Dennis Stricker, MA, CMS/OCSQ/ISG</i>
10:30 AM - 10:45 AM	Break
10:45 AM - 11:45 AM	“Payment for Outpatient Maintenance Dialysis Services Furnished by ESRD Facilities - Paying for Services in the ESRD Program” <i>Suzanne W. Asplen, Chronic Care Management, Chronic Care Policy Group, Center for Medicare Management, CMS</i>
11:45 AM - 12:30 PM	Luncheon
12:30 PM - 2:00 PM	Motivational Presentation: “An Artist’s Journey Through Transplantation and Recovery” <i>Sekou Sundiata</i>
2:00 PM - 3:45 PM	“Working Together to Make a Difference – Roles & Responsibilities & Examples of Successful Renal Partnerships” <i>Gina Clemons, MHA, Panel Moderator</i>
2:00 PM - 2:30 PM	Partnership: Survey & Certification/Network “Sanctions Process” <i>Diane Carlson, Network 11, and Judith Kari, CMS</i>
2:30 PM - 3:00 PM	Partnership: Large Dialysis Organization/Network “A Successful Partnership Story Where Outcomes Exceed Expectations” <i>Carol DiRaimondo, MD</i>
3:00 PM - 3:45 PM	Partnership: QIO/Network “Opportunities for Cooperation Between QIOs and ESRD Networks” <i>David Schulke, Moderator, and Logan Malone, EdD, FMQAI</i>
3:45 PM - 4:00 PM	Break
4:00 PM - 4:45 PM	“Can We Do Things Better? ESRD Disease Management Demonstration” <i>Ron Deacon, PhD, CMS</i>
4:45 PM - 5:30 PM	2005 Forum Membership Meeting
5:30 PM - 7:30 PM	Poster Reception: “Quality Partnerships”

Program Agenda

TUESDAY, MARCH 15, 2005

7:30 AM - 5:15 PM	Registration
7:30 AM - 5:15 PM	Poster Display
7:30 AM - 8:30 AM	Continental Breakfast
8:30 AM - 10:30 AM	Training Session: "Strategic Partnership for Change" <i>Tom Wolff, PhD -Facilitator</i> <i>Suzanne Boyer Cashman, ScD,</i> <i>Gillian Kaye</i>
10:30 AM - 10:45 AM	Break
10:45 AM - 12:15 PM	Training Session, continued
12:15 PM - 1:15 PM	Luncheon (Buffet)
1:15 PM - 3:00 PM	Training Session, continued
3:00 PM - 3:15 PM	Break
3:15 PM - 4:30 PM	Training Session, continued
4:30 PM	Adjourn

Program Agenda

WEDNESDAY, MARCH 16, 2005

7:30 AM - 5:15 PM	Registration
7:30 AM - 8:00 AM	Continental Breakfast
8:00 AM - 9:15 AM	General Session: "ESRD Disaster Response Planning" <i>Joan Solanchick, Moderator</i> <i>Kelly Mayo, MS, Network 7</i> <i>Harry Mayer, MGA, National Disaster Medical System. FEMA</i> <i>Tom Mignone, MPH, Regional #3 Emergency Coordinator, CDC</i> <i>Glenda Payne, MS, RN, CN, CMS Dallas RO</i> <i>Polly Weaver, Agency for Healthcare Administration</i>
9:15 AM - 10:00 AM	General Session: "Decreasing Dialysis Patient-Provider Conflict" Project Update <i>Glenda Harbert, RN, CNN, CPHQ, and Richard S. Goldman, MD</i>
10:00 AM - 10:15 AM	Break
10:15 AM - 11:45 AM	General Session: "Our Journey to Performance Excellence" <i>G. Richard Hastings, FACHE</i>
11:45 AM - 1:15 PM	Lunch - on your own
1:15 PM - 3:00 PM	Open Specialist Meetings
<i>Track 1: 1:15 PM - 3:00 PM</i>	Quality Track: "Quality, Quality, Quality!" <i>G. Richard Hastings, FACHE</i> - OR -
<i>Track 2: 1:15 PM - 3:00 PM</i>	Information Technology Track: CROWN/Web Requirements
3:00 PM - 3:15 PM	Break
3:15 PM - 5:00 PM	Open Specialist Meetings continued
<i>Track 1: 3:15 PM - 5:00 PM</i>	Quality Track: "Quality, Quality, Quality!" cont. <i>G. Richard Hastings, FACHE</i> - OR -
<i>Track 2: 3:15 PM - 5:00 PM</i>	Information Technology Track: CROWN/Web Requirements
5:00 PM	Adjourn

Program Agenda

THURSDAY, MARCH 17, 2005

7:30 AM - 12:15 PM	Registration
7:30 AM - 8:00 AM	Continental Breakfast
8:00 AM - 10:00 AM	General Session: "Promoting Adult Immunizations in the ESRD Community" <i>Craig Hales, MD, MPH, CMS, Moderator</i> <i>Jackie Harley, CMS</i> <i>Stephen Jencks, MD, MPH</i> <i>Michael Lazarus, MD, Fresenius Medical Care North America</i> <i>Chris Lovell, RN, MSN, CNN, Dialysis Clinic, Inc.</i> <i>Barry Straube, MD, CMS</i> <i>Ray Strikas MD, CDC</i>
8:00 AM - 10:00 AM	Closed Specialist Business Sessions - Network Data Managers
10:00 AM - 10:15 AM	Break
10:15 AM - 10:45 AM	General Session: "National Patient Safety Initiative " <i>Alan Kliger, MD and Jenny Kitsen</i>
10:45 - 11:30 AM	General Session: "Conditions for Coverage Decisions" <i>Teresa Casey, RD, LD</i>
11:30 AM - 12:00 Noon	Closing Remarks and Adjourn <i>Mark B. McClellan, MD, CMS Administrator</i> <i>Derrick Latos, MD, MACP, President, Forum Board of Directors</i> <i>Joan Solanchick, 2005 Annual Meeting Program Chair</i>
1:30 - 5:30 PM	Breakthrough Initiative: FistulaFirst - Stakeholders' Meeting (Invited participants)

Note: The 2005 CMS/Forum of ESRD Networks' Annual Meeting will be followed on Thursday, March 17, 2005, by The ESRD Stakeholder's Meeting sponsored by the Centers for Medicare & Medicaid Services. This meeting will also take place at the Baltimore Marriott Inner Harbor at Camden Yards in Baltimore, Maryland.



DISTINGUISHED SPEAKERS

Suzanne Asplen is a Health Insurance Specialist in the Division of Chronic Care Management/Chronic Care Policy Group/Center for Medicare Management at CMS. She develops and implements policy on Medicare payments to ESRD facilities. Recently, she has worked on the implementation of changes in the way Medicare pays ESRD facilities as required by The Medicare Prescription Drug, Improvement and Modernization Act (MMA) of 2003. She has worked in ESRD policy since 2000. Previously, she worked on the implementation of the Hospital Outpatient Prospective Payment System, and prior to that the Inpatient Hospital Capital Prospective Payment System. She has eleven years experience in several different areas of payment policy and has been at CMS for a total of eighteen years.

Diane Carlson has 25 years of experience working for the Renal Network of the Upper Midwest and 30 years of experience working in quality improvement. She has worked in the hospital, nursing home, Quality Improvement Organization, and ESRD Network environments. Her background in Health Information Administration contributes to her commitment to data driven quality improvement.

Teresa Casey, RD, LD is the Technical Advisor in the Division of Non-Institutional Quality Standards/Clinical Standards Group/Office of Clinical Standards and Quality at CMS and is the lead clinical analyst for the Medicare ESRD Conditions for Coverage. She earned her Bachelor of Science degree at Hood College in Frederick, Maryland, and attended graduate school at the Old Dominion University, Norfolk, Virginia. She is a Registered and licensed dietitian with 16 years of clinical experience. Teresa started her professional career in a community hospital where she worked on a variety of medical/surgical and specialty units, including the hospital out patient dialysis unit. She also has experience in Skilled and Intermediate Long-term Care, Acute Care, Critical Care, Rehabilitation, and Home Care. Prior to coming to CMS in 2000, Teresa worked with chronic kidney disease patients for nearly 9 years in the Baltimore area. Teresa serves on the ESRD CPM Quality Improvement Committee and provides technical assistance within CMS regarding ESRD Quality Measures, Dialysis Facility Compare Website and CAHPS Patient Experience of Care projects, ESRD demonstration projects, and ESRD Patient and Staff Education.

Suzanne Cashman, ScD is formally trained in health services research, evaluation and administration. She has spent the twenty-five years of her professional career teaching graduate courses in public health, conducting evaluation research, and developing partnerships aimed at helping communities improve their health status. Currently, Dr. Cashman is an Associate Professor and Director of Community Health in the Department of Family Medicine and Community Health at the University of Massachusetts Medical School (UMMS). Also Assistant Director for the University's Preventive Medicine Residency, Dr. Cashman has leadership responsibilities for developing the Department's community health agenda and administrative/teaching responsibilities in the residency. In addition, she carries out community-based evaluation research, provides evaluation technical assistance to the Office of Community Programs, and teaches public health skills to medical students and residents, as well as students in the Graduate School of Nursing and the School of Public Health. Dr. Cashman joined the UMMS faculty in 1999, after having spent the preceding decade developing a community-oriented primary care (COPC) focused preventive medicine residency in Boston, MA. Currently, Dr. Cashman serves as a Board and Executive Committee member of the Association of Teachers of Preventive Medicine; she is also on the board of Community Partners, Inc.

Gina Clemons, MHA is the Director of the End State Renal Disease (ESRD) Network Program at the Centers for Medicare & Medicaid Services (CMS), in the Office of Clinical Standards and Quality (OCSQ). In this capacity, Ms. Clemons is the Agency focal point for program operation, policy development, and oversight of the ESRD Quality Improvement Program and Federal official responsible for national matters pertaining to the development, implementation, and monitoring of the ESRD Network contractors. She is a technical expert on ESRD QI Program issues, including emerging issues resulting from new legislation and Administration priorities such as the Fistula First Breakthrough Initiative. Prior to her current position, Ms. Clemons was a Director in the Center for Medicaid and State Operations (CMSO), Disabled and Elderly Health Programs Group (DEHPG) with responsibility for eligibility, enrollment, and outreach, and the technical expert on Medicare and Medicaid dual eligibility. Prior to her employment with CMS, she was the National Director of Provider Relations at a dental management organization.



DISTINGUISHED SPEAKERS

Ron Deacon, PhD, is the Director of the Division of Delivery Systems in the Office of Research, Development and Information (ORDI) CMS. His division develops and implements demonstrations involving alternative payment methodology and delivery systems. Current initiatives include demonstrations in End Stage Renal Disease incorporating alternative payment and quality incentives.

Louis Diamond, MB, ChB, FACP, has served on countless renal-related boards and committees over the years, including as a delegate for the American Medical Association's House of Delegates and past President and Medical Director of the Renal Physicians Association. He is a former Robert Wood Johnson Health Policy Fellow and currently serves as Medical Director and Vice President of Medstat, a provider of information solutions for healthcare. Dr. Diamond is also President of the Forum of ESRD Networks.

Carol DiRaimondo, MD is a nephrologist practicing with Diable Nephrology Medical Group, Inc., in Walnut Creek, CA. She received her undergraduate degree from Stanford University, and her medical degree from Vanderbilt University School of Medicine. Dr. DiRaimondo is the Medical Review Board Chair for ESRD Network 17.

Elizabeth Goldstein, PhD is Director of the Division of Beneficiary Analysis in the Center for Beneficiary Choices (CBC) at CMS. This division is responsible for all of the Medicare CAHPS Surveys, the assessment of activities related to CMS's National Medicare & You Education Program, research related to public reporting for CMS's Quality Initiatives, and the consumer and social marketing research related to CMS's communication activities with people with Medicare. In addition to her work in CBC, she has conducted research and has published articles related to long-term care, home health care, comparative behavior of for-profit and nonprofit organizations, integrated health care delivery systems, child day care, and substance abuse treatment programs. She received her Ph.D. in economics from the University of Wisconsin in Madison.

Craig Hales, MD, MPH is a preventative medicine physician and is a member of the Quality Coordination Team in the Office of Clinical Standards and Quality at the Centers for Medicare & Medicaid Services.

Thomas Hamilton is the Director of the Survey and Certification Group at the Center for Medicaid and State Operations at the Centers for Medicare & Medicaid Services.

Glenda Harbert, RN, CNN, CPHQ has twenty plus years as a nephrology nurse in positions from staff nurse to Corporate VP of a national company. She was QM coordinator for ESRD Network 8 years prior to promotion to Executive Director in 1996. Ms. Harbert is certified in Nephrology & Quality Management and has served on many CMS and ANNA committees and provided over 100 presentations on various nephrology subjects.

Jacqueline C. Harley is the Centers for Medicare & Medicaid Services' Co-Government Task Leader for the Quality Improvement Organizations' Underserved and Rural Beneficiary Disparities Project. A project focused on reducing health disparities and increasing access to care. Ms. Harley previously served as the Coordinator of CMS's National Influenza and Pneumococcal Campaign, Team Leader for CMS/CDC's Standing Orders Project, Lead for the Good Neighbor Flu Project and Co-Lead for the Horizons Pilot Project. Ms. Harley works in the Office of Clinical Standards and Quality's Quality Improvement Group. She has experience in the areas of Federal contracting, quality improvement programs, and health promotion and disease prevention.

Richard Hastings, FACHE is the President and Chief Executive Officer (CEO) of the St. Luke's Health System in Kansas City, Missouri. The St. Luke's Health System (encompassing eleven hospitals with over 1,200 combined licensed beds) received the 2003 Malcolm Baldrige National Quality Award. Mr. Hastings received his BS from the University of Oklahoma, his MBA from Chapman University, and his MHA from the University of Minnesota. He currently serves on the faculty of the graduate program in healthcare administration at Washington University, St. Louis, Missouri, and is a clinical preceptor for the University of Minnesota. He has authored numerous publications in the field of healthcare, finance, and product line management.



DISTINGUISHED SPEAKERS

Lisa Hines, MS, BSN currently provides senior leadership to the CMS Quality Initiatives and measure development. While Director of the Division of Ambulatory and Post Acute Care, she led the successful implementation of the Nursing Home and Home Health Quality Initiatives for which the Nursing Home team received awards from both then CMS Administrator Tom Scully and HHS Secretary Tommy Thompson. Ms. Hines holds a B.S. degree in Nursing from Salisbury State University and a M.S. degree in Health Care Administration from Wilmington College

Stephen Jencks, MD, MPH is Director of Quality Improvement Coordination in the Office of Clinical Standards and Quality, Centers for Medicare & Medicaid Services (CMS, formerly HCFA). He leads a small team that is responsible for coordinating quality improvement efforts within CMS and between CMS and other healthcare stakeholders. Dr. Jencks graduated from Harvard College, Harvard Medical School, and the Johns Hopkins School of Hygiene and Public Health and is board-certified in psychiatry and in general preventive medicine. He held clinical, management, planning, and research positions in the Public Health Service Hospital system and the National Institute of Mental Health before joining CMS in 1984. Dr. Jencks also served as Assistant Surgeon General in the U.S. Public Health Service from 2000 to 2004.

Judith Kari is a member of the Survey & Certifications Group in the Center for Medicaid and state Operations at the Centers for Medicare & Medicaid Services (CMS).

Gillian Kaye is an international community development consultant in the areas of organizational and leadership development, coalition building, strategic planning, community organizing and training. She has extensive experience providing training, consultation and technical assistance to grassroots community organizations, coalitions, community organizers, non-governmental organizations, foundations, law enforcement personnel, social service providers and intermediary organizations. Her more than 20 years of experience in the field of community development and training include 6 years as Director of Neighborhood Services and Training for the Citizens Committee for New York City, a non-profit technical assistance organization servicing over 15,000 grassroots neighborhood groups and as an agency Chief of Staff for the New York City Mayor's Office. Prior to working for ASDC, her consulting firm, Community Development

Consultants, was retained by foundations, city, state and federal governments, universities and non-profit organizations in the United States, Russia and the Czech Republic. She has also authored and co-authored manuals, articles and training curricula on coalition building, grassroots organizing, community-based drug prevention, community leadership development and developing support and training systems for community organizing and development.

Jenny Kitsen has served as Executive Director of the ESRD Network of New England (Network 1) since 1978. She is a member of the Forum of ESRD Networks' Board of Directors. Prior to her work with the ESRD Networks, Ms. Kitsen was employed as a social worker at Yale-New Haven Hospital in Connecticut. Ms. Kitsen is the author of numerous publications and has presented at multiple national conferences.

Alan S. Kliger, MD is a Clinical Professor of Medicine, Yale University School of Medicine, and Chairman, Department of Medicine Hospital of St. Raphael, New Haven, Connecticut. He serves as past and present Board of Directors of the Forum of ESRD Networks, and is a director for the ESRD Network of New England. He is on the steering committee for the NIH Chronic Kidney Disease Education Project, and is chairman of the steering committee for the NIH Frequent Dialysis Study. He is an officer and member of the RPA Board of Directors, and serves on its Quality Patient Care Committee. Dr. Kliger has received several teaching awards from the Yale house staff, and in February 2000 was the recipient of the James Colangelo award of the Connecticut National Kidney Foundation for distinguished service to the renal community.

Derrick Latos, MD, MACP has been in private practice since 1977, Dr. Latos is senior member of a 4 nephrologist group in Wheeling, WV. Currently serving as President of the Forum of ESRD Networks and Chair of the ACP Council of Subspecialty Societies, he is a Past President of the Renal Physicians Association and previously chaired the CMS Practicing Physicians Advisory Council. He is a member of the Board of Directors of the NKF of Western Pennsylvania, West Virginia Medical Institute, and the NKF K/DOQI Advisory Committee. He has been a member of the ESRD Network 5 (MARC) Board since 1977, and is a Clinical Professor of Medicine at West Virginia University School of Medicine.



DISTINGUISHED SPEAKERS

Michael Lazarus, MD is the Chief Medical Officer and Senior Vice President of Clinical Quality for Fresenius Medical Care North America and is Vice Chairman of the Board of Directors of Renaissance Health Care, Inc. and member of the Medical Advisory Board of Optimal Renal Care.

Chris Lovell, RN, MSN, CNN is a Corporate Nurse; Information Technology Development, Education and Security Officer; Corporate Quality Management Committee; and Clinical Liaison to Government and Private Health Plans for Dialysis Clinic, Inc.

Thomas Logan Malone, Jr. was appointed chief executive officer of Florida Medical Quality Assurance, Inc. (FMQAI) in October 2001. Dr. Malone's background includes executive management and leadership positions specializing in strategic planning, quality improvement, financial management and education. Dr. Malone served as chief executive officer of Mid-South Foundation for Medical Care, Inc., Tennessee's quality improvement organization that sought to improve the health status of that state's Medicare beneficiaries. He is currently a member of both the Health Care Compliance Association and the American Healthcare Quality Association. Dr. Malone is a retired rear admiral with the U.S. Navy who directed strategic and tactical operations of U.S. and NATO submarines throughout the world. He later worked in national procurement for nuclear submarines and weapons components. During his Navy career he was also responsible for basic and technical training of nearly 14 percent of all Navy personnel and designed, delivered and evaluated academic programs. He managed a several hundred million dollar annual budget while overseeing operation and maintenance of national Naval training facilities. Currently, he is a member of the Navy League of the United States, a civilian organization dedicated to educating citizens and supporting men and women of the sea services and their families. Dr. Malone is a graduate of the U.S. Naval Academy in Annapolis, Maryland. He holds a doctorate in education and master's degree in economics, both from Memphis State University.

Harry A. Mayer, MGA, is currently an Emergency Coordinator for the U.S. Department of Homeland Security, National Disaster Medical System (NDMS). His geographic territory includes Pennsylvania, Delaware, Maryland, Virginia, West Virginia and the District of Columbia. Prior to coming to NDMS, he was the Director of Emergency Services for the Southeastern Pennsylvania Chapter of the American Red Cross (2000-2002) and the Project Officer for the Metropolitan Medical Response System (MMRS) for US Public Health Service Region III. Highlights of his disaster experience include conducting a medical assessment of the Government of Greece's infrastructure for the 2004 Olympic Games, responding to the 2003 catastrophic earthquake in Bam, Iran and the 2004 Florida Hurricane Season.

Kelly M. Mayo, MS is Project Director for FMQAI: The Florida ESRD Network. She has worked in the renal community since 1992, beginning her career as a patient care technician. Her experience includes work at all levels of the Network organization; both statewide and national presentations; and various publications, abstracts and posters. Ms. Mayo currently serves on the Board of Directors for the National Kidney Foundation of Florida and the American Association of Kidney Patients. She received the NKF of Florida's President's Award in 2001 and its Volunteer Award in 2000. Ms. Mayo earned a Master of Science Degree in Health Sciences from the University of Central Florida

Thomas Mignone, MPH, CDR is a U.S. Public Health Service Emergency Coordinator, assigned since April jointly to the Regional Health Administrator, Region III, Philadelphia and to the Centers for Disease Control and Prevention (CDC) National Center for Environmental Health. He has previously served as Director, National Disaster Medical System- Operations Support Center (OSC), Rockville, MD, and as the Emergency Coordinator for the U.S. PHS Office of Emergency Preparedness, in the New York regional office. In that capacity, he was responsible for planning, managing and coordinating federal health, medical, and health related services, for response and recovery to major emergencies and federally declared disasters. He was the lead emergency coordinator for the response actions following the World Trade Center attack, New York City Anthrax Postal Mission, American Airlines Flight 571 crash, and pre-deployment operations for the 56th United Nations General Assembly Meeting.



DISTINGUISHED SPEAKERS

Additionally, he was deployed to Kuwait and Qatar prior to and during the Iraq War, assisting with WMD preparedness activities, and to natural disasters both within and outside of the continental United States. He received a B.S. from Rutgers University/Cook College, an M.P.H. from Robert Wood Johnson Medical School, and is a 2003 graduate of the U.S. Naval War College, Newport, RI.

Glenda Payne, MS, RN, CNN comes from a clinical background in transplantation, and worked as a surveyor in ESRD for more than 20 years. She is currently the ESRD clinical lead for Regions 4 & 6 for CMS, and the Project Officer for Network 7. She was actively involved in the planning and response to the four hurricanes that struck Florida in 2004.

William Rollow, MD, MPH is a board-certified family physician and Director of the Quality Improvement Group at the Centers for Medicare and Medicaid Services. Dr. Rollow brings to CMS an extensive background in managed care and medical management, having held senior medical director positions at BlueCross BlueShield of Illinois and at Anchor HMO, a large staff model plan based in Chicago. The Quality Improvement Group has responsibility for the Medicare Quality Improvement Organization (QIO, formerly Peer Review Organization or PRO) program and the ESRD Networks program. As Director, Dr. Rollow seeks to further develop these programs as national resources for promoting transformational improvement in healthcare quality.

David Schulke has served since 1998 as Executive Vice President of The American Health Quality Association (AHQA), where he represents the national network of health care Quality Improvement Organizations (QIOs). He has worked full time on health quality issues since 1978, including over twenty years in Washington, D.C. While working for the Congress, Mr. Schulke played an instrumental role in drafting and securing enactment of several significant pieces of health legislation, including the Medicare hospital quality oversight reforms enacted in the late 1980s, nursing home reforms enacted in OBRA 87, the first Medicare outpatient drug benefit enacted in the Medicare Catastrophic Coverage Act of 1988, the OBRA 90 Medicaid drug rebate and drug use review legislation, and the first Federal quality "report card" evaluating health care services (infertility clinics), enacted in 1993.

Mr. Schulke was born in California, where from 1978 to 1983 he worked with and then led a community-based organization that vigorously advocated the interests of residents of long term care facilities, focusing on quality and access problems.

Joan Solanchick, RN, MSW has served as ESRD Network Executive Director for, initially, the New Jersey area and, later, also Puerto Rico and the Virgin Islands with responsibility for quality improvement activities and oversight. Ms. Solanchick earlier served in the PHS, HSQB, HCFA, later known as DHHS, New York regional office as ESRD consultant responsible for program implementation and oversight. She also was employed as a consultant in a federally-funded program that sought to bring research results from university settings to community hospitals, and special assignment as neighborhood health center administrator. Her early clinical experience includes public health nursing and internal medicine nursing in a university hospital environment. Ms. Solanchick has consulted for state and local health planning agencies and state divisions in regard to facility use, service availability and data utilization.

Dennis Stricker, MA is currently the Director of the Information Systems Group (ISG) of the Centers for Medicare & Medicaid Services' (CMS) Office of Clinical Standards and Quality (OCSQ). ISG is responsible for providing information systems support for the two major programs within OCSQ: the Quality Improvement Organization (QIO) Program and the End Stage Renal Disease (ESRD) Program. For the QIO Program, ISG manages the continued development and support of the QIO Standard Data Processing System. For the ESRD Program, ISG manages the development and integration of three ESRD data systems: the Standard Information Management System; the Renal Management Information System; and the Vital Information System for Improved Outcomes in Nephrology. Mr. Stricker earned a Bachelor of Arts degree in Political Science from Marquette University in 1978, and a Master of Arts degree in Public Policy and Administration from the University of Wisconsin - Madison in 1987. Mr. Stricker joined CMS (then the Health Care Financing Administration) in 1987 as a Presidential Management Intern. Prior to his current tenure in OCSQ, Mr. Stricker worked in CMS' contracts and budget components.



DISTINGUISHED SPEAKERS

Raymond A. Strikas, MD received his undergraduate and doctor of medicine degrees from the University of Illinois in Chicago, the latter in 1978. He completed training in internal medicine in 1981, and in infectious diseases in 1983, both at the Hines Veterans' Affairs Medical Center and Loyola University Medical Center near Chicago. He is board-certified in both internal medicine and infectious diseases. Dr. Strikas has worked on adult immunization issues, particularly influenza and pneumococcal vaccines, and pandemic influenza preparedness and response planning. In addition, he was also a physician-trainer, and directed smallpox preparedness and response activities, all with the National Immunization Program (NIP) at the Centers for Disease Control and Prevention (CDC). As of May, 2004, he is the Associate Director for Adult Immunization in the Immunization Services Division at NIP. He has been at CDC continuously since 1989, having previously worked in the Epidemic Intelligence Service at CDC between 1983 and 1985. He is an acknowledged national authority on vaccine-preventable diseases, the vaccines to prevent them, and he has authored or co-authored over 40 articles and book chapters on these subjects.

Barry M. Straube, MD is currently the Chief Medical Officer for the Centers for Medicare & Medicaid Services (CMS), Region IX. Dr. Straube is the only nephrologist at CMS and serves as an internal clinical consultant to Brady Augustine and the CMS Administrator on ESRD issues. As Chief Medical Officer for CMS, Region IX, Dr. Straube is involved with all aspects of CMS business, including Medicare, Medicaid, the State Children's Health Insurance Program, Survey & Certification Activities, and numerous CMS Quality Initiatives.

Sekou Sundiata is a poet who writes for print, performance, music and theater. Born in Harlem, Sundiata came of age as an artist during the Black Arts/Black Aesthetic movement of the 1960s and 1970s. He has been a Sundance Institute Screenwriting Fellow, a Columbia University Revson Fellow, a Master Artist-in-Residence at the Atlantic Center for the Arts (Florida) and the first Writer-in-Residence at the New School University in New York. He was featured in the Bill Moyers' PBS series on poetry, "The Language of Life," and as part of Russell Simmons' *Def Poetry Jam* on HBO. Sundiata is currently a professor at Eugene Lang College in New York City.

He has written and performed in the highly acclaimed performance theater works --*The Circle Unbroken is a Hard Bop*, which toured nationally and received three AUDELCO Awards and a BESSIE Award; *The Mystery of Love*, commissioned and produced by New Voices/New Visions at Aaron Davis Hall in New York City and the American Music Theater Festival in Philadelphia; and *Udu*, a music theater work produced by 651 ARTS in Brooklyn and presented by the International Festival of Arts and Ideas in New Haven, the Walker Art Center and Penumbra Theater in Minneapolis, Flynn Center in Burlington, VT, the Hopkins Center at Dartmouth College in New Hampshire, and Miami-Dade Community College in Florida.

Sundiata's most recent theatrical piece, *blessing the boats*, brings the story of five tumultuous years of his life into perspective as it relates his experience with the life threatening illness and recovery of kidney failure and organ transplant. This work opened in November 2002 and continues to tour nationally. Sundiata has recorded and performed his poetry with a range of musicians, including Craig Harris, David Murray, Nona Hendryx and Vernon Reid. His first recording, *The Blue Oneness of Dreams* (Mouth Almighty/Mercury), and its successor, *longstoryshort* (Righteous Babe Records), are both rich with the sounds of blues, funk, jazz and African and Afro-Caribbean percussion. He has toured internationally with his band; in 2001, they performed in 23 cities in the United States and Canada as part of Ani DiFranco's "Rhythm and News Tour."

Sean Tunis, MD, MSc is the Director and Chief Medical Officer, Office of Clinical Standards and Quality, at the Centers for Medicare & Medicaid Services.

Polly A. Weaver received her Bachelor of Science degree in Medical Technology from Stetson University, DeLand, Florida, awarded August 1979. With over 20 years of regulatory experience, since 1995, she has been the Chief of Field Operations for the Division of Health Quality Assurance, Agency for Health Care Administration. Responsibilities include management of the eight Agency for Health Care Administration field offices located throughout Florida. In addition, she currently oversees the staff training and quality assurance program as well as complaint administration activities. Her clinical expertise is in laboratory medicine. She has worked as a Medical Technologist in the reference, hospital and physician office laboratory arenas.

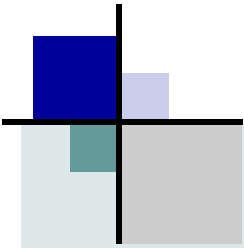

DISTINGUISHED SPEAKERS

Tom Wolff, PhD, is a nationally recognized consultant on coalition building and community development, with over 30 years' experience training and consulting with individuals, organizations and communities across North America. His clients include federal, state and local government agencies; foundations; hospitals; non-profit organizations; professional associations; and grassroots groups. Tom Wolff's writings on coalition building include the popular book *From the Ground Up: A Workbook on Coalition Building and Community Development* (1997 with Gillian Kaye), and *The Spirit of the Coalition* (2000 with Bill Berkowitz), published by the American Public Health Association. He co-authored *Outreach Works: Strategies for Expanding Health Access in Communities* in 2001. From 1985 to 2002, Dr. Wolff founded and directed *Community Partners*, a technical assistance and training program in coalition building and community development affiliated with the University of Massachusetts Medical School. Dr. Wolff is a Fellow of the American Psychological Association, which granted him its 1985 National Career Award for Distinguished Contributions to Practice in Community Psychology and its 1993 Henry V. McNeil award for Innovation in Community Mental Health. In 2000, he received the For the People Against the Tide Award from Health Care for All for his "outstanding efforts to energize and educate local communities in areas of health care justice". He has held academic appointments at the University of Massachusetts School of Public Health, the University of Massachusetts Medical School Department of Family Medicine and Community Health and Wellesley College's Stone Center. He received his undergraduate degree from Clark University and his Ph.D. from the University of Rochester.

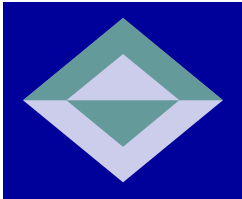

POSTER SESSION-LIST OF POSTER ABTRACTS

Abstract Title and Presenting Organization

ESRD NETWORK OF NEW ENGLAND, INC. (Network 1)

- "New England Dialysis Social Worker Survey"
- "FistulaFirst Video: Patient Education Tool"
- "Patient Education in New England: The Creative Process"

ESRD NETWORK OF NEW YORK, INC. (Network 2)

- "Network 2 Employee Recognition Program"
- "The Effect of Glycosylated Hemoglobin and Lipid Levels on Survival in Diabetics Receiving Dialysis"

ESRD NETWORK 4, INC., RENAL NETWORK OF THE UPPER MIDWEST, INC. (Network 11), and ESRD NETWORK ORGANIZATION #13

- "Partnering with SSA and CMS in the Sanctions Process: The Experience of Three Networks"

MID-ATLANTIC RENAL COALITION (Network 5)

- "Caring through the End: Palliative Care Along the Continuum of CKD"

SOUTHEASTERN KIDNEY COUNCIL, INC. (Network 6)

- "Search" and find the "Key" to quality care when we put "People First". Collaboration makes our "Mission Possible"

FMQAI: THE FLORIDA ESRD NETWORK (Network 7)

- "Successful Disaster Planning Through Strategic Partnerships"

NETWORK 8, INC.

- "ESRD Outpatient Medications Project"

THE RENAL NETWORK, INC. (Network 9/10)

- "Keys to Partnership"

ESRD NETWORK #12

- "The Network #12 Approach to Partnerships & Collaborations"
- "Patient Education Newsletter: Putting the "U" in Fist-U-la"

ESRD NETWORK ORGANIZATION #13

- "Where We Started, The Efforts Made To Improve, and Where We Are"

ESRD NETWORK OF TEXAS, INC. (Network 14)

- "Network 14 & FMC of Texas: Partnership for Patient Care"

INTERMOUNTAIN ESRD NETWORK, INC. (Network 15)

- "The Impact of Pre-Dialysis Care From Indian Health Service (IHS) Physicians on AV Fistula Rates"

NORTHWEST RENAL NETWORK (Network 16)

- "Getting Technical! Monitoring Your Dialysis Water Treatment System"

SOUTHERN CALIFORNIA RENAL DISEASE COUNCIL, INC. (Network 18)

- "San Diego Vascular Access Coalition: Successful Improvement Model"

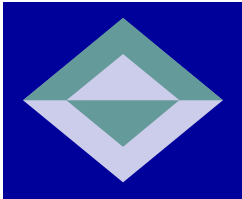

POSTER SESSION-LIST OF POSTER ABTRACTS

Abstract Title and Presenting Organization

CENTERS FOR MEDICARE & MEDICAID SERVICES

“Working Together to Improve Care; The End Stage Renal Disease (ESRD) Quality Initiative

MARGARET SMITH WASHINGTON

“Doctor, Can You Hear Me? Patient, Are You Listening?”

MEDICAL EDUCATION INSTITUTE

“ESRD Networks and the Medical Education Institute: Areas of Partnership”

AMGEN

“Amgen & The ESRD Networks: A Partnership to Achieve Quality Goals for Anemia & Secondary Hyperparathyroidism”

DECREASING DIALYSIS PATIENT- PROVIDER CONFLICT

“A Collaborative ESRD Stakeholder Initiative”

“Taxonomy & Glossary”



MEETING ANNOUNCEMENT

Please Join Us

2006 CMS/Forum of ESRD Networks'
Annual Meeting

DATE:

April 3 – 6, 2006

LOCATION:

Baltimore Marriott Waterfront Hotel

700 Aliceanna Street

Baltimore, MD 21202

Phone: (410) 385-3000

www.marriott-hotels.com



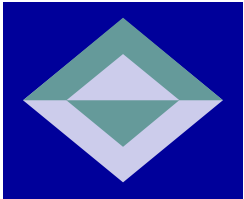

NOTES

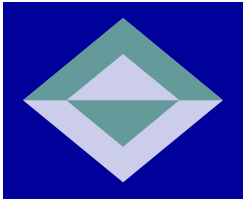

NOTES

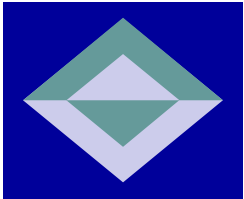

NOTES